

Brake	Item	Description	Code	A	B	C	Q.ty	Kit code
40G	1	Drum 8 holes for M20	S66LTG0801	220	275	120	1	<b>S66LTG0801</b>
		Drum 10 holes for M22	S66LTG1001	280	335	118	1	<b>S66LTG1001</b>
	2a	Brake assembly B.1117	S9FCA400Z0	-	-	-	1	<b>OSB0TG01</b>
	2b	Twin washer M24	S9800241	-	-	-	1	
	2c	Nut M24X1,5	S97124B1	-	-	-	1	
	2a	Brake assembly RAD	S731TC02	-	-	-	1	<b>OSB0TGA1</b>
	2b	Twin washer M24	S9800241	-	-	-	1	
	2c	Nut M24X1,5	S97124B1	-	-	-	1	
	2a	Brake assembly FRASLE	S9FCA400ZF	-	-	-	1	<b>OSB0TGB1</b>
	2b	Twin washer M24	S9800241	-	-	-	1	
	2c	Nut M24X1,5	S97124B1	-	-	-	1	
	3	Camshaft	S753032D...	33	(1)	-	1	<b>S753032D...</b>
	4a	O-ring	S53103301	-	-	-	1	<b>OSBC3201</b>
	4b	Camshaft bush	S771011	-	-	-	1	
	4c	Grease nipple 45° M06X1,00	S9860612	-	-	-	1	
	4d	Seeger Ø32	S58511	-	-	-	1	
	4e	Rubber cover	S53AP01T	-	-	-	1	
	5a	Lever	S7619401	225	-	-	1	<b>S7619401</b>
	5b	Slack adjuster	S7623203	200	-	-	1	<b>OSBR3201</b>
	5c	Seeger Ø28	S58509	-	-	-	1	
5d	Return spring	S738201	-	-	-	1		
6	Spring	S738117	-	-	-	2	<b>OSB0TG02</b>	

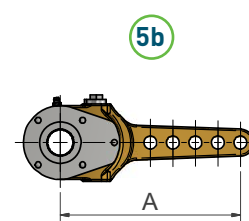
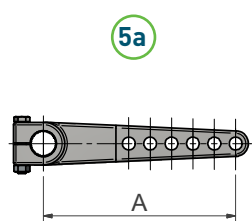
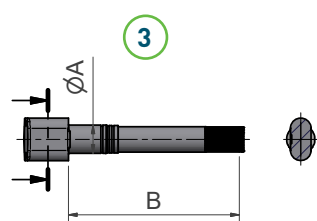
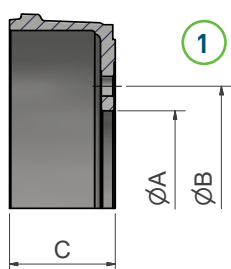

(1) From 100 to 400mm step 25mm. From 400 to 1200mm step 50mm.