

MOTORE "M+S HYDRAULIC"
"M+S HYDRAULIC" MOTOR
MOTOR "M+S HYDRAULIC"

ALBERO CILINDRICO Ø40
PARALLEL SHAFT Ø40
ZYLINDRISCHE WELLE Ø40

FLANGIA QUADRA - 4 FORI
SQUARE FLANGE - 4 HOLES
FLANSCH - 4 BOHRUNGEN



MPT (MT)

Standard: CONNESSIONI LATERALI - SIDE PORTS - ANSCHLÜSSE SEITLICH

VALVOLE UNIDIREZIONALI INCORPORATE
BUILT-IN CHECK VALVES
EINGEBAUTE RÜCKSCHLAGVENTILE

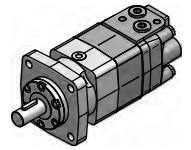
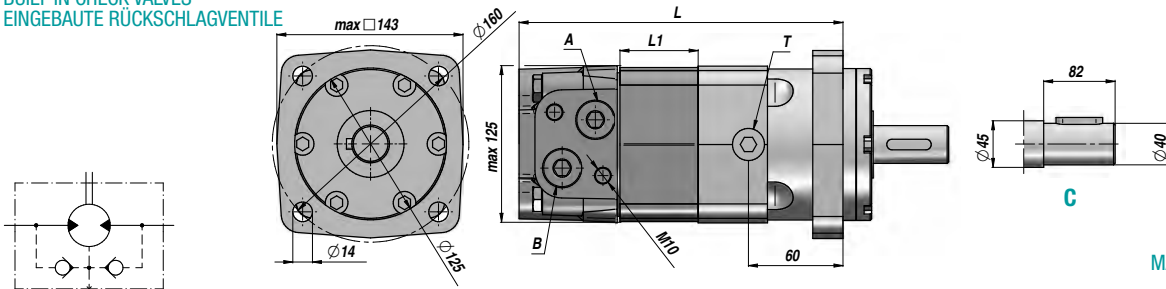

PREDISPOSTO PER IL DRENAGGIO
MACHINED FOR DRAIN CONNECTION
FÜR DRÄNLEITUNG GEEIGNET

Codice Code Bestell-Nr.	Tipo Type Typ	cm ³ /giro cm ³ /rev cm ³ /U	n. Max giri/min rpm - U/Min.	M Max daNm	Q MAX l/min	P MAX bar			A - B	T	L	L1	kg
						Caduta Drop Gefälle Δp	Ingresso Inlet Eingang	Ritorno Return Rücklauf					
LAVORO CONTINUO - CONTINUOUS WORK - DAUERARBEIT													
MPT160NC40	MPT 160 C	161,1	622	47	100	200	210	140 *	3/4"	1/4"	190	16,5	20,00
MPT200NC40	MPT 200 C	201,4	620	59	125	200	210	140 *			195	21,5	20,50
MPT250NC40	MPT 250 C	251,8	496	73	125	200	210	140 *			201	27,8	21,00
MPT315NC40	MPT 315 C	326,3	382	95	125	200	210	140 *			211	37,0	22,00
MPT400NC40	MPT 400 C	410,9	304	108	125	180	210	140 *			221	47,5	23,00
MPT500NC40	MPT 500 C	523,6	238	122	125	160	210	140 *			235	61,5	24,00
MPT630NC40	MPT 630 C	631,2	197	130	125	140	210	140 *			231	57,5	24,00
MPT725NC40	MPT 725 C	724,3	172	127	125	120	210	140 *			240	66,5	24,50

* = CON DRENAGGIO - WITH DRAIN - MIT DRÄNLEITUNG

OPTION	OPTION	OPTION	PRESSIONE MAX. AL RITORNO SENZA DRENAGGIO MAX. RETURN PRESSURE WITHOUT DRAIN MAX GEGENDRUCK OHNE DRÄNLEITUNG
<p>CO</p>	<p>W: (Wheel Mount)</p>	<p>E: CONNESSIONI POSTERIORI REAR PORTS ANSCHLÜSSE HINTEN</p>	
<p>K</p>			
<p>SH</p>			
<p>SL</p>			
<p>CARICHI AMMESSI SULL'ALBERO PERMISSIBLE SHAFT LOADS ZULÄSSIGE WELLENBELASTUNGEN</p>			
<p>Albero - Shaft - Welle : "C-CO-K-SH-SL"</p>			

VERSIONI SPECIALI - SPECIAL VERSIONS - SPEZIELLE VERSIONEN

W: versione ruota - wheel mount - Radversion
S/V: versioni corte - short versions - kurze Versionen
M: versione rinforzata - reinforced version - verstärkte Version