

**CARATTERISTICHE**

Luce nominale	<b>Pagina seguente/next page</b>
Portata min/max	<b>Pagina seguente/next page</b>
Pressione max. di picco	<b>350 bar 5075 PSI</b>
Pressione max. di taratura	<b>Pagina seguente/next page</b>
Rapporto di pilotaggio standard	<b>Pagina seguente/next page</b>
Temperatura ambiente	<b>-30°C + 50°C</b>
Temperatura olio	<b>-30°C + 80°C</b>
Filtraggio consigliato	<b>30 + 50</b>
Coppia di serraggio	<b>Pagina seguente/next page</b>
Peso	<b>0.7-0.9-0.1-2 kg</b>

**PERFORMANCE**

Rated size
Min/max flow-rate
Max peak pressure
Max setting pressure
Standard pilot ratio
Room temperature
Oil temperature
Recommended filtration
Tightening torque
Weight

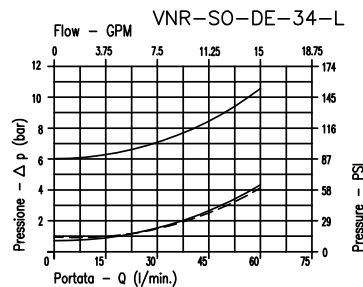
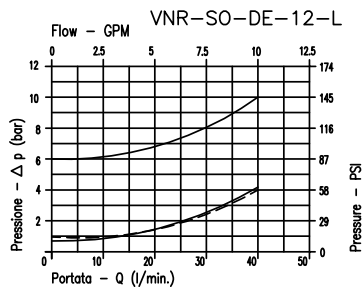
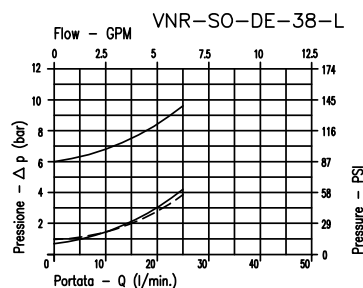
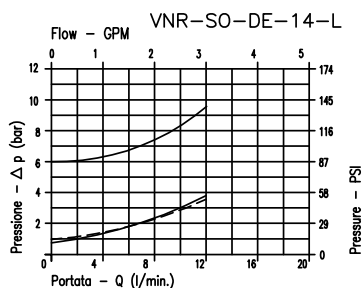

——— 8Bar Flusso libero (Free flow)  
 - - - - 1Bar Flusso libero (Free flow)  
 ——— Flusso pilotato (Piloted open)

Viscosita' olio 46 cSt a 50 °C  
 Oil viscosity 46 cSt at 50 °C

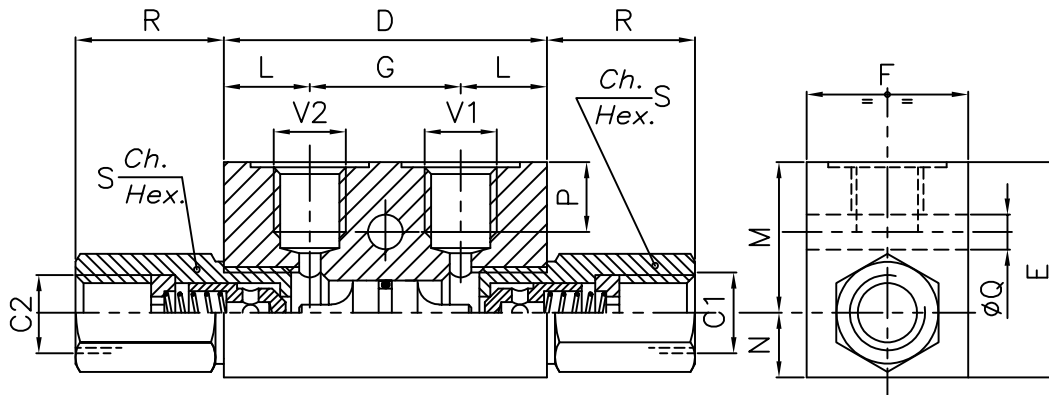

**DIMENSIONI  
DIMENSIONS**

NUMERO VALVOLA VALVE NUMBER	D	E	F	G	L	M	N	P	Q	R	S	Attacchi Port size V2-C2 V1-C1 GAS (BSPP)	Luce nominale Rated size DN	Rapporto di pilotaggio Pilot ratio	Portata max max flow-rate l/min-GPM
030	60	40	30	28	16	28	12	13	6.5	27	19	1/4"	6	4:1	10-3.2
031	70	50	35	38	16	35	15	15	6.5	29	24	3/8"	8	4:1	23-6
032	80	50	35	38	21	34	16	15	6.5	32	27	1/2"	11	4:1	40-10.6
033	100	60	40	50	25	39	21	15	8.5	41	38	3/4"	16	3.5:1	60-15.8

**COLLETTORE IN ALLUMINIO  
ALUMINIUM BODY**

**CODICE DI ORDINAZIONE  
HOW TO ORDER**

003	033	0	W	0
Numero valvola / Valve number			Inizio apertura Cracking pressure	
030			J 1 bar Molla (colore nero) Spring (black)	
031	A O-RING sul pist. di pilotaggio Pilot piston O-RING		W 6÷8 bar Molla (colore giallo) Spring (yellow)	
032	O Senza O-RING sul pist. di pilotaggio No pilot piston O-RING			
033				