

## SPLINEHYLSER FOR HYDRAULIKKGEAR

Modell	D1	Antall tenner	D2	Modul	Ant. Z <sup>2</sup>	D3	L1	L2	L3	L4	L5	L6	C1	C2	C3	C4	Best.nr.	Pris/stk.
--------	----	---------------	----	-------	---------------------	----	----	----	----	----	----	----	----	----	----	----	----------	-----------

### KON 1 : 5

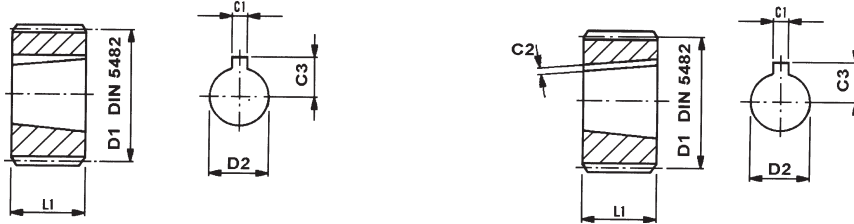

BF1B	20x17	12	7,60	-	-	-	12	-	-	-	-	-	2	1	-	-	DT31000600	©PPF
BF2/1B	25x22	14	7,60	-	-	-	10	-	-	-	-	-	2	1	-	-	DT31001800	©PPF
BF2B	25x22	14	12,90	-	-	-	20	-	-	-	-	-	3	-	9,2	-	DT31000900	©PPF
BF2BZ15	28x25	15	12,90	-	-	-	20	-	-	-	-	-	3	1,9	-	-	DT31002100	©PPF
BF2,5/2B	32x28	17	12,90	-	-	-	20	-	-	-	-	-	3	1,9	-	-	DT31002800	©PPF
BF2,5	32x28	17	15,20	-	-	-	24	-	-	-	-	-	4	2,1	-	-	DT31002900	©PPF
BF3/2B	35x31	18	12,90	-	-	-	20	-	-	-	-	-	3	1,9	-	-	DT31004100	©PPF
BF3/2,5B	35x31	18	15,20	-	-	-	24	-	-	-	-	-	4	2,1	-	-	DT31005300	©PPF
BF3B	35x31	18	19,50	-	-	-	25	-	-	-	-	-	5	-	13,7	-	DT31003600	©PPF

### DIN 5482 / SAE

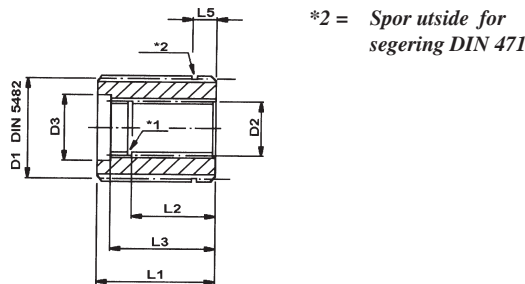

\*1 = Spor innside for segering DIN 472

BF3/13	16/32"DP	35x31	18	16/32"DP	1,587	13		35					5	-	-	-	-	DT31004400	324,-
BF3/15	16/32"DP	35x31	18	16/32"DP	1,587	15	26	40	32	35			7	-	-	-	-	DT31005200	473,-
BF3,5/13	16/32"DP	40x36	20	16/32"DP	1,587	13		35					5	-	-	-	-	DT31018000	594,-
BF3,5/15	16/32"DP	40x36	20	16/32"DP	1,587	15	26	40	32	35			7	-	-	-	-	DT31014700	716,-
BF4/13	16/32"DP	48x44	23	16/32"DP	1,587	13	23	46	41,5	10			3,5	-	-	-	-	DT31007700	637,-
BF4/15	16/32"DP	48x44	23	16/32"DP	1,587	15	26	40	32	35			7	-	-	-	-	DT31009500	945,-
BF4/21	16/32"DP	48x44	23	16/32"DP	1,587	21		50	40				6	20	-	-	-	DT31014900	995,-
BF4/14	12/24"DP	48x44	23	12/24"DP	2,116	14	32,5	49	45,2				8	16	-	-	-	DT31009900	918,-

### DIN 5482 FOR PARALLELL PUMPER

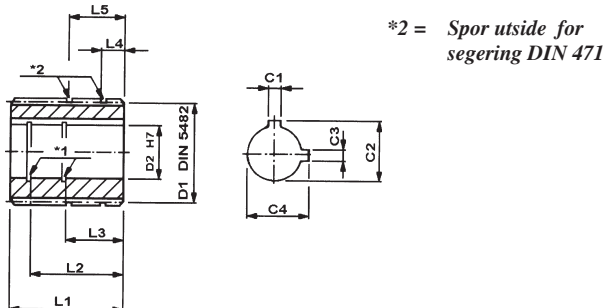

\*1 = Spor innside for segering DIN 472

BF3A		35x31	18	19,05	-	-	-	48	41	26	13	27	-	4,8	21,3			DT31004700	581,-
BF3/B+B1		35x31	18	22,22	-	-	-	48	40	26	14	27	-	4,8	24,4	6,4	25,2	DT31025700	423,-
BF3,5/A		40x36	20	19,05	-	-	-	41	36	23	9	13	-	4,8	21,3			DT31026100	©PPF
BF3,5/B+B1		40x36	20	22,22	-	-	-	45	32		4	10	-	4,8	24,4	6,4	25,2	DT31032800	1.268,-
BF4/A		48x44	23	19,05	-	-	-	49	40	26	8	25	-	4,8	21,3			DT31008700	©PPF
BF4/B+B1		48x44	23	22,22	-	-	-	50	42	26	8	25	-	4,8	24,4	6,4	25,2	DT31025400	571,-
BF4/C+C1		48x44	23	31,75	-	-	-	60	55	41	8	20,5	-	6,4	34,6	8	35,3	DT31025300	©PPF