



Mix&Match to Get What You Need

Donaldson's Mix&Match system provides the great performance and functional advantages of custom-engineered filters with the convenience and speedy delivery of in-stock parts. Choose your options and build a filter model that exactly suits your cleanliness requirements.

Technical Data

- Operating pressure up to 1000 kPa (10 bar).
- Static pressure testing up to 1500 kPa (15 bar).
- Operating temperature -20 +120°C.
- Compatibility with hydraulic fluids per ISO 2943.
- Flow rate and pressure drop determined per ISO 3968 with oil kinematic viscosity 30 cSt at 40°C and density 0,875 kg/dm³.
- Flange per SAE J518: 3000 PSI.

Filter Elements

- Wire mesh: 60-90 micron.
- Cellulose media: 36-50 micron, reinforced with wire mesh.
- Synteq® synthetic media: 11-23 micron.
- By-pass valve setting 150 kPa (1,5 bar) per ISO 3968.
- Collapse resistance 1000 kPa (10 bar) per ISO 2941.
- Replacement element includes spring and O-ring seal.

Components



Family	WIRE MESH				CELLULOSE MEDIA				SYNTHETIC MEDIA				CARTRIDGE CODE
	/9		/6		/3		/1		/03		XP10		
	90µm		60µm		$\beta_{50\mu m(c)} \geq 1000$		$\beta_{36\mu m(c)} \geq 1000$		$\beta_{23\mu m(c)} \geq 1000$		$\beta_{11\mu m(c)} \geq 1000$		
	RMF		RMF	RMF		RMF		RMF	RMF		RMF		
FIO20	20	P171500	20	P171505	15	P171504	15	P171503	10	P171502	10	P171501	CR30
FIO30	30	P171500	30	P171505	20	P171504	20	P171503	15	P171502	15	P171501	CR30
FIO50	50	P171518	50	P171523	35	P171522	35	P171521	30	P171520	30	P171519	CR50
FIO60	60	P171524	60	P171529	40	P171528	40	P171527	35	P171526	35	P171525	CR60
FIO80	80	P171530	80	P171535	55	P171534	55	P171533	50	P171532	50	P171531	CR100
FIO100	80	P171530	80	P171535	65	P171534	65	P171533	60	P171533	60	P171531	CR100
FIO140	140	P171831	140	P171834	100	P171837	100	P171840	90	P171843	90	P171846	CR150
FIO150	150	P171536	150	P171541	100	P171540	100	P171539	90	P171538	90	P171537	CR180
FIO180	180	P171536	180	P171541	120	P171540	120	P171539	110	P171538	110	P171537	CR180
FIO200	200	P171542	200	P171547	140	P171546	140	P171545	130	P171544	130	P171543	CR201
FIO250	250	P171548	250	P171553	160	P171552	160	P171551	140	P171550	140	P171549	CR250
FIO325	330	P171554	330	P171559	200	P171558	200	P171557	180	P171556	180	P171555	CR325
FIO330	330	P171560	330	P171565	200	P171564	200	P171563	180	P171562	180	P171561	CR330
FIO500	500	P171566	500	P171571	400	P171570	400	P171569	350	P171568	350	P171567	CR500
FIO600	600	P171572	600	P171577	500	P171576	500	P171575	400	P171574	400	P171573	CR600
FIOF600	600	P171572	600	P171577	500	P171576	500	P171575	400	P171574	400	P171573	CR600
FIO800	800	P171578	800	P171583	600	P171582	600	P171581	500	P171580	500	P171579	CR800
FIOF800	800	P171578	800	P171583	600	P171582	600	P171581	500	P171580	500	P171579	CR800

RMF = Recommended Maximum Flow in liters/minute with use of standard housing
 Maintain the filter outlet (ref. diameter F) well below the oil level to avoid foam formation.

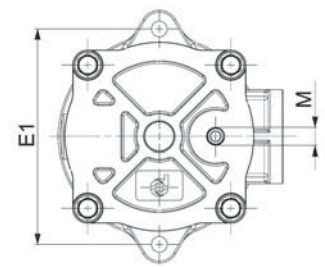
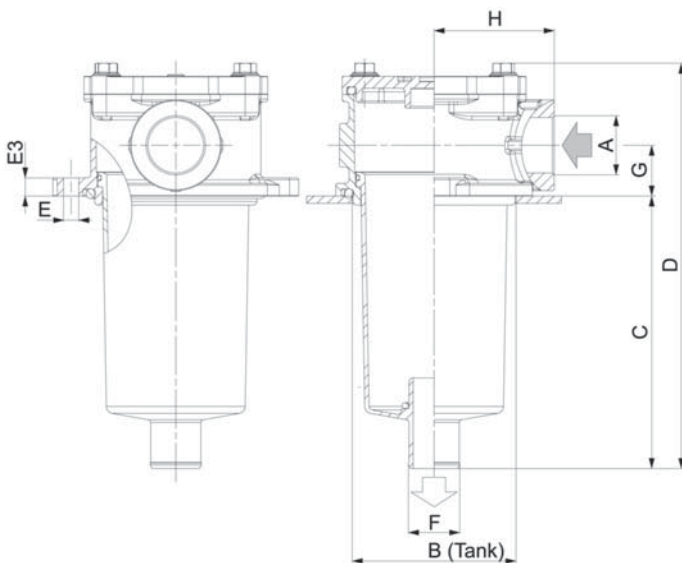

FIO 20-30

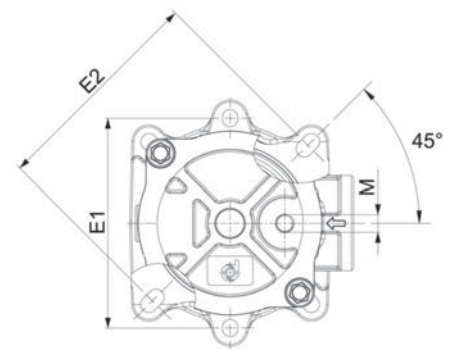

FIO 50-140



Standard Housing without Cartridge	HOUSING DIMENSIONS																CARTRIDGE DIMENSIONS			POSSIBLE INDICATOR
	A	B	C	D	E	E1	E2	E3	F	G	H	V	W	T	M	N	X	Y	Z	
		mm	mm	mm	mm	mm	mm	mm	mm	mm	mm	mm	mm	mm		predrilled holes	plugged	mm	mm	
P766446	G3/8	67	78	132	6,4	90		9	25	22	49				G1/8	yes	67	52	25.5	P171953 P171958 P171966 P173104
P766447	G1/2	67	78	132	6,4	90		9	25	22	49				G1/8	yes	67	52	25.5	
P766448	G1/2	90	100	172	8,4	115	126	10	28	28	66				G1/8	yes	75	70	29	
P766449	G3/4	90	100	172	8,4	115	126	10	28	28	66				G1/8	yes	82	70	29	
P766450	G3/4	90	150	222	8,4	115	126	10	28	28	66				G1/8	yes	128	70	29	
P766451	G1	90	150	222	10,5	115	126	10	28	28	66				G1/8	yes	128	70	29	
P766675	G1	90	234	307	8,5	115	126	10	40	29,5	67,7				G1/8	yes	209	70	42	
P766452	G1	130	224	314	10,5	175		10	40	35	95				G1/8	yes	203	95	41	
P766453	G1 1/4	130	224	314	10,5	175		10	40	35	95				G1/8	yes	203	95	41	
P766454	G1 1/4	130	278	368	10,5	175		10	40	35	95				G1/8	yes	250	95	41	
P766455	G1 1/2	174	167	273	10,5	220		10	50	41	120				G1/8	yes	136	140	52	
P766456	G1 1/2	174	242	248	10,5	220		10	50	41	120				G1/8	yes	203	140	52	
P766457	G1 1/2	174	240	346	10,5	220		10	63,5	41	120				G1/8	yes	203	140	65	
P766458	G2	174	240	346	10,5	220		10	63,5	41	120				G1/8	yes	203	140	65	
P766459	G2	174	294	400	10,5	220		10	63,5	41	120				G1/8	yes	250	140	65	
P766460	Flange 2"	174	290	395,5	10,5	220		11	63,5	48,5	120	77,8	42,9	M12	G1/8	yes	250	140	65	
P766461	G2	174	437	543	10,5	220		10	63,5	41	120				G1/8	yes	400	140	65	
P766462	Flange 2"	174	433	538	10,5	220		11	63,5	48,5	120	77,8	42,9	M12	G1/8	yes	400	140	65	

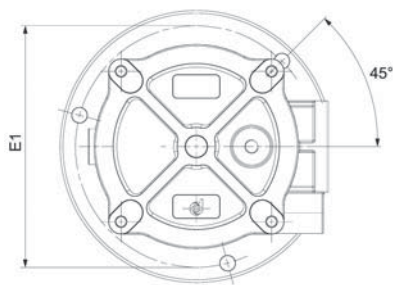

FIO 150-200

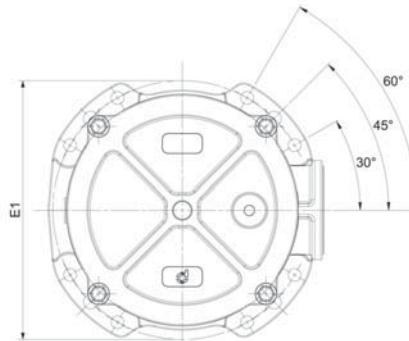

FIO 250-800

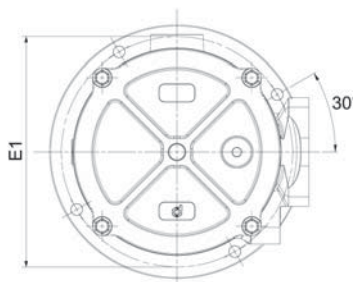
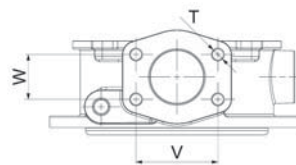

FIOF 600-800

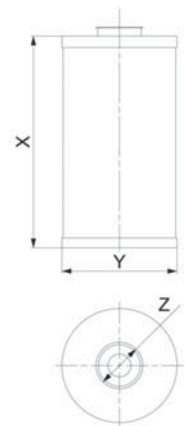

Indicator Choices

Indicator	Kind	Reference Drawing	Setting (bar)	Contact	Protection Class	Cable Clamp	Max. Values
P171966	Electrical	C	1,2	Normally Open	IP65	PG7	48 V; 0,5 A res. and 0,2 A ind.
P173104	Electrical	C	1,2	Normally Closed	IP65	PG7	48 V; 0,5 A res. and 0,2 A ind.
P171958	Visual	F	1,2				
P171953	Visual	G	range -1/5				

Installation & Service Guidelines

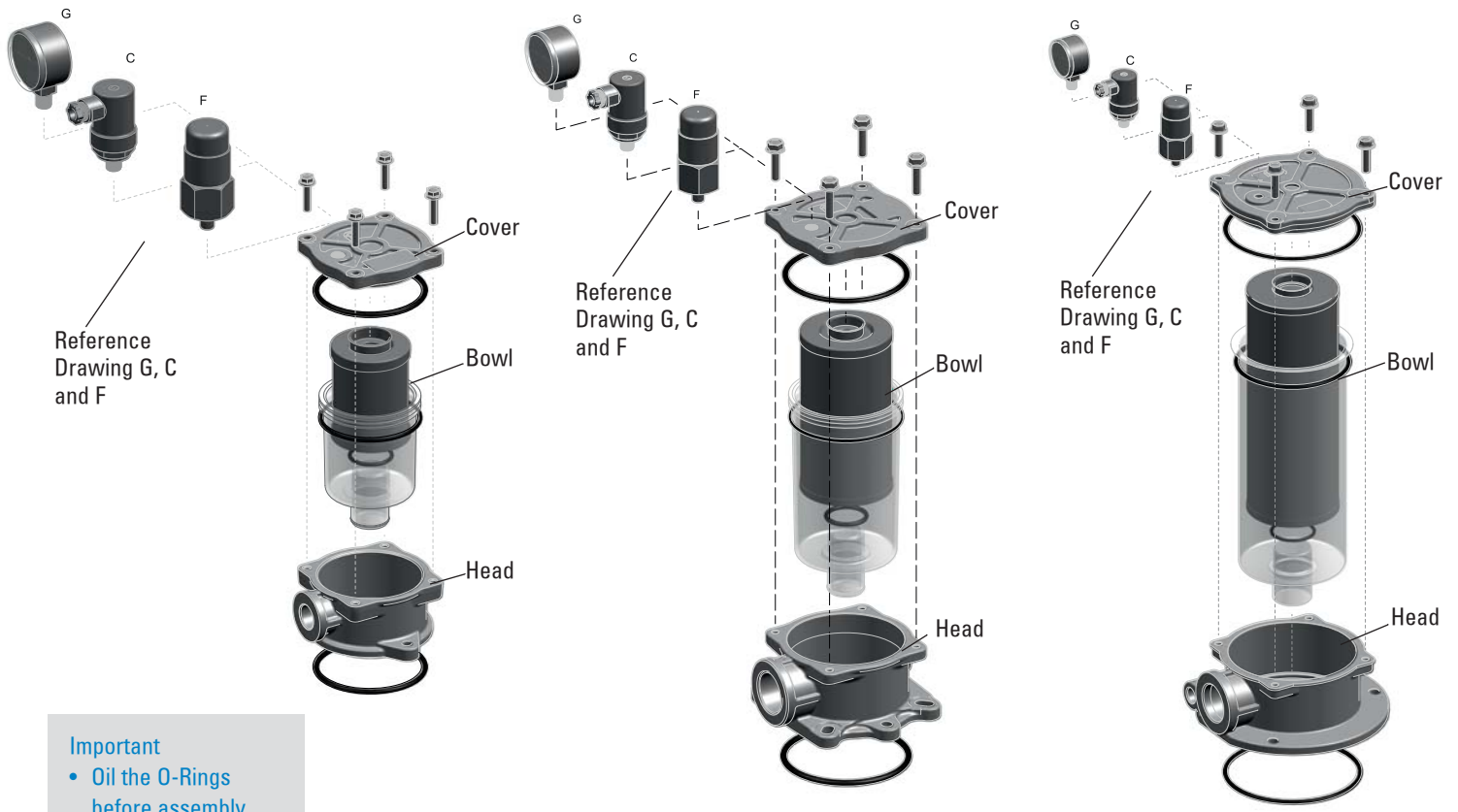

FIO 20-30

FIO 50-140

FIO 150-800

Performance Curves

