

BR
40 - 80 - 120 - 160 - 200 - 240 - 280

BR EVO
50 - 90 - 170 - 260

Technical catalogue
Catalogo tecnico
Technischer Katalog



Battioni®
Pagani

Setting the pace since 1953

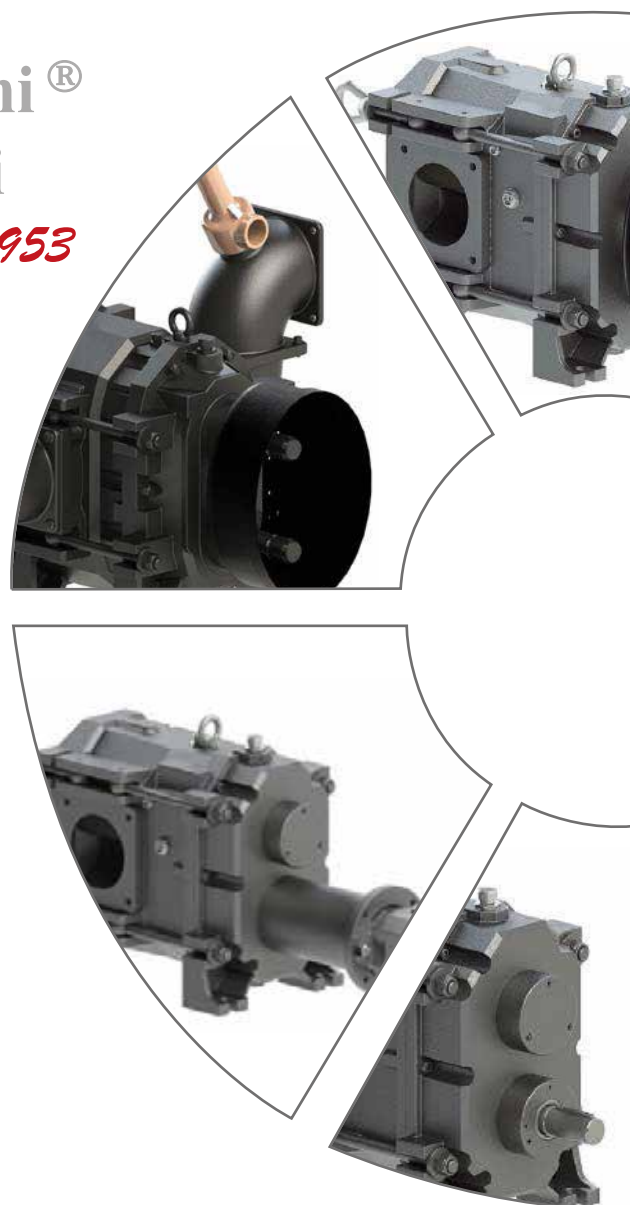
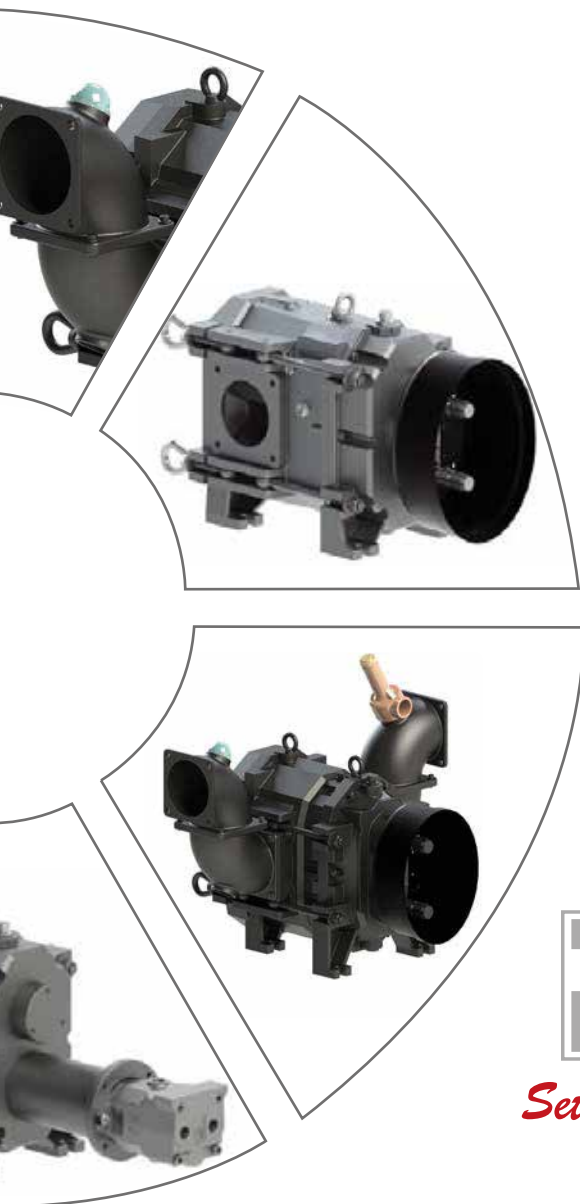



**Battioni®
Pagani**

Setting the pace since 1953

Low cost stator and lobes replacement

Sostituzione economica di statori e lobi
Wirtschaftlicher Austausch von Statoren und Kolben

Wear-resistant special steel plates standard

Piastre anti-usura in acciaio speciale di serie
Spezielle Verschleißschutzplatten serienmäßig



**Available coatings are:
NBR rubber, SBR rubber,
FKM rubber, EPDM rubber**

Rivestimenti disponibili:
gomma NBR, gomma SBR,
gomma FKM, gomma EPDM

Verfügbare Ummantelung:
NBR, SBR, FKM und EPDM

Bilobe rotors

Rotori bilobati
Doppelkolbenrotoren

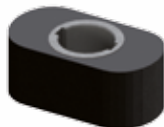

**Double splined shaft to reverse
rotational direction**

Doppio albero per versione D per
invertire senso di rotazione

Doppelte Welle für Ausführung D zur
Inversion der Rotationsrichtung



Self Priming
Rotary Lobe
Liquid Transfer
Pumps



● **FKM sealings up to 10 bar resistant**

Tenute in FKM per pressioni fino a 10 bar
Dichtungen aus FKM für Druck von bis zu 10 bar

● **Double bearings shaft support for high pressure resistance**

Albero sostenuto da due cuscinetti per alte pressioni
Welle gehalten von zwei Hochdrucklagern

VERSIONS



BR - D



BR - EL



BR - H



BR - HM



BR - P

BR Ideal for high pressures





BR

40 - 80 - 120 - 160 - 200 - 240 - 280



**Battioni®
Pagani**

Setting the pace since 1953

BR – The simply reliable

The BR series of positive displacement rotary lobes pumps are utilized for liquids and muds handling. It requires absence of abrasives and solid bodies less than 20mm wide. The BR series is equipped by replaceable wear-resistant plates to reduce maintenance costs. The BR features a robust design thanks to the double shaft support that enables operation at high working pressure and significant vibrations reduction. The BR simple and modular design gives high performances at low cost. The pump is ideal for agricultural applications or as auxiliary pump in vacuum trucks.



VERSIONS

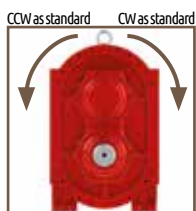

Version P
BR 40/80/120/160
Smooth Cylindrical shaft,
Ø 38, length 100 mm
Parallel key UNI 6604
BR 200/240/280
Smooth Cylindrical shaft,
Ø 48, length 120 mm
Parallel key UNI 6604

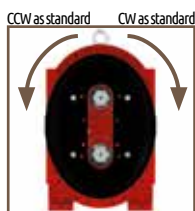

Version D
Splined shaft
1"3/8 - Z6 ISO 500

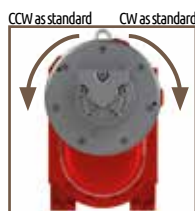

Version H
304 cc/rev
Pmax 250 bar
In G 1" - Out G 1"

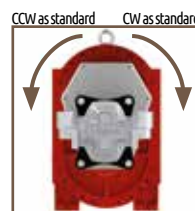

Version HM
Group 3
73,82 cc/rev
Pmax 180 bar
In G 1" - Out G 1" 1/4

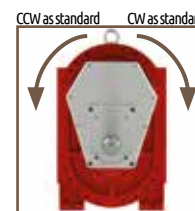

Version EL
Splined shaft
1"3/8 - Z6 ISO 500

TECHNICAL DATA

	Geometrical capacity			Max rpm			Max Pressure Abs Bar (PSI)		Power Required at Max Pressure kW (hp)		Weight kg				
	m³/h	l/min	cfm	P/D	H	HM/EL	P/D/H	HM/EL	P/D/H	HM/EL	P	D	H	HM	EL
BR 40	42	710	25	540	/	1620	10 (145)	10 (145)	13 (17,4)	13 (17,4)	101	103	/	122	107
BR 80	85	1425	50	540	/	1620	10 (145)	10 (145)	27 (36,2)	27 (36,2)	119	121	/	142	125
BR 120	127	2125	75	540	/	1620	10 (145)	6 (87)	39 (52,2)	25 (33,5)	137	139	/	158	143
BR 160	172	2875	101	540	/	1620	8 (116)	5 (72)	43 (57,6)	29 (38,9)	161	163	/	182	167
BR 200	210	3500	123	540	540	/	7 (101)	/	48 (64,3)	/	181	182	237	/	/
BR 240	255	4250	150	540	540	/	6 (86)	/	50 (67,0)	/	197	198	252	/	/
BR 280	297	4950	174	540	540	/	5 (72)	/	52 (69,7)	/	217	218	272	/	/

OPTIONALS



SBR Rubber Lobes



EPDM Rubber Lobes

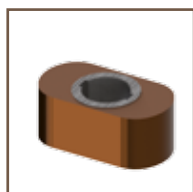

FKM Rubber Lobes



Lubricated Sealings Kit



BR Elbows Kit

Code 6080200024 - BR 80
Code 6080200025 - BR 120
Code 6080200026 - BR 160
Code 6080200027 - BR 200
Code 6080200028 - BR 240
Code 6080200029 - BR 280



Overpressure Valve 2" - 2" 1/2

Code 5100200033
BR 40-80-120-160
Code 5100200034
BR 200-240-280



Customized Painting



Coupling Flange BR

Code 5010401021 - BR 40
Code 5010401012 - BR 80
Code 5010401013 - BR 120
Code 5010401014 - BR 160
Code 5010401015 - BR 200
Code 5010401016 - BR 240
Code 5010401017 - BR 280



FLOW-PRESSURE CHARTS

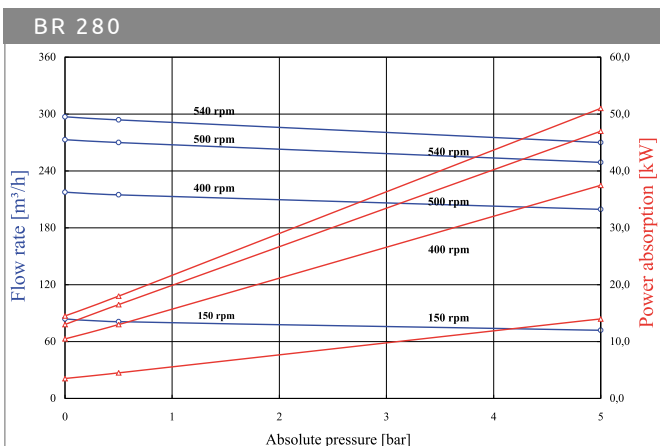
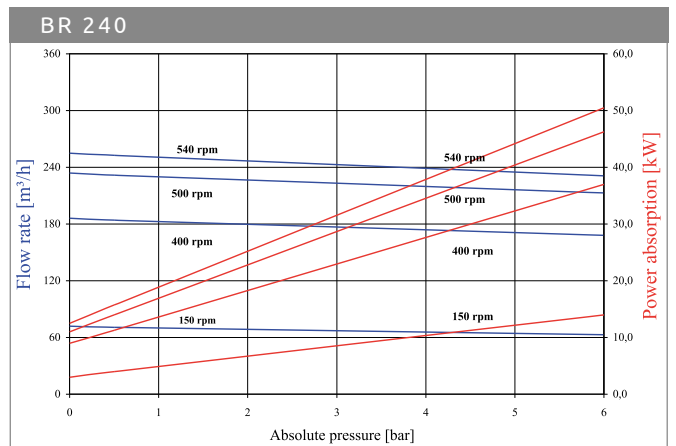
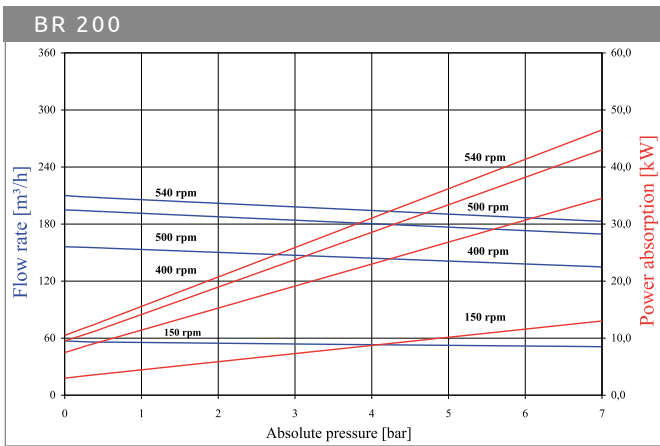
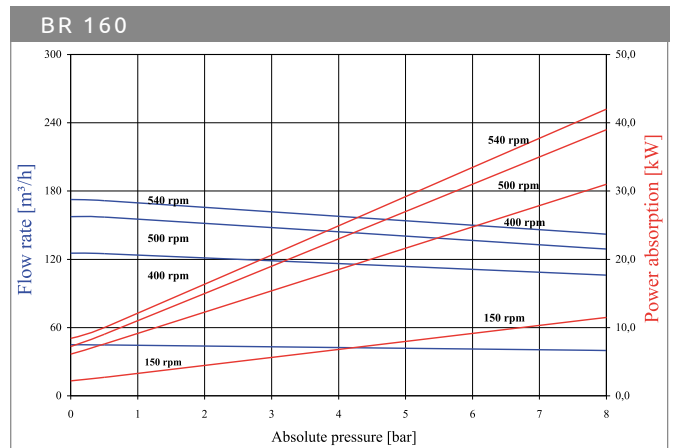
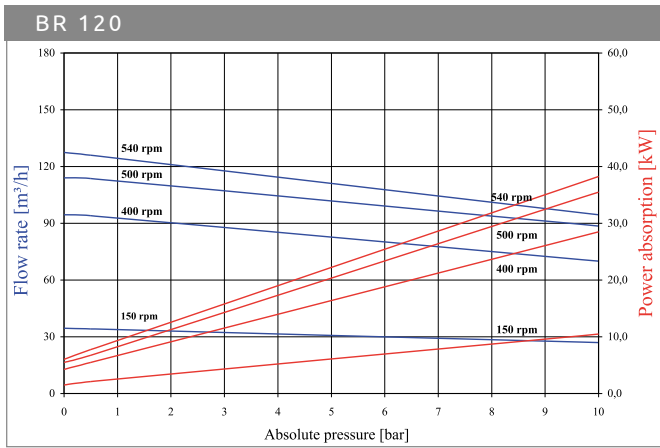
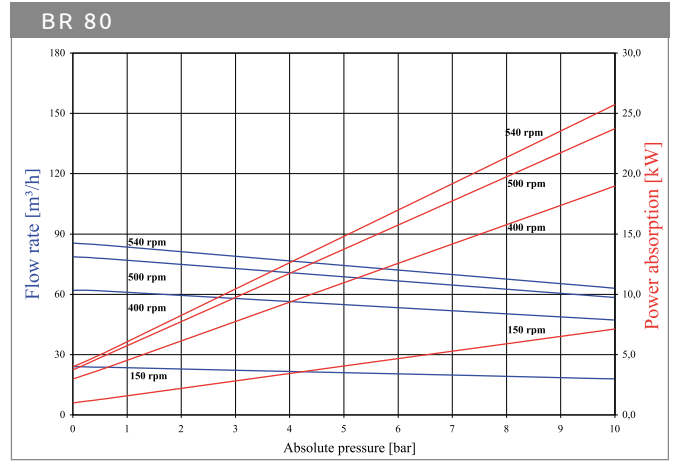
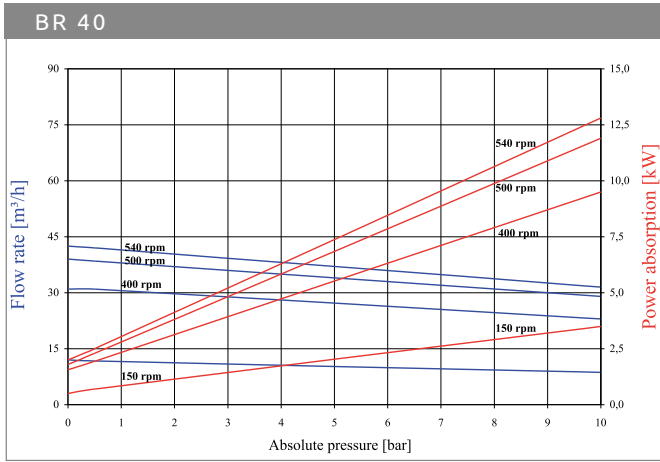

Self-Priming Rotary Lobe
Liquid Transfer Pumps



Easy maintenance rear shaft support (standard on BR EVO 170 and 260)

Supporto posteriore per alberi easy maintenance (di serie per BR EVO 170 e 260)

Halterung vorn für Wellen Easy Maintenance (serienmäßig für BR EVO 170 und 260)

Friendly Maintenance

Facile manutenzione e pulizia

Einfache Wartung und Reinigung



Trilobe rotor design standard. Available coatings are: NBR rubber, FKM rubber, EPDM rubber.

Geometria trilobata del rotore di serie.
Rivestimenti disponibili: gomma NBR, gomma FKM, gomma EPDM.

Kleeblattform des serienmäßigen Rotors.
Verfügbare Ummantelung: NBR, SBR, FKM und EPDM



Tungsteno carbide (Widia) seals: specifically designed for heavy duty applications to grant maximum wear-resistance

Tenute meccaniche in carburo di tungsteno (Widia): studiate per usi gravosi e anti-usura.

Dichtungen aus Wolframcarbid (Widia) für den Einsatz hart und Anti-Verschleiß

**Seals cooling room standard
The seals cooling room is included as standard feature to grant the cooling and lubrication of the tungsten carbide seals (Widia).**

Camera raffreddamento tenute di serie. Permette il raffreddamento e la lubrificazione delle tenute in carburo di tungsteno (Widia).

Raumkühlung erforderlichen Standard. Ermöglicht Kühlung und Schmierung von Dichtungen in Wolframcarbid (Widia).

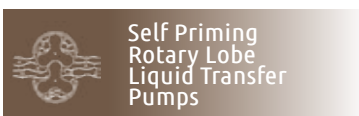



Heavy duty shafts standard

Alberi per usi gravosi di serie
Wellen für starke Beanspruchung serienmäßig

Wear-resistant special steel plates standard

Piastre anti-usura in acciaio speciale di serie
Spezielle Verschleißschutzplatten serienmäßig

VERSIONS



BREVO - D



BREVO - P



BREVO - H

BR EVO Friendly Maintenance from rear cover!

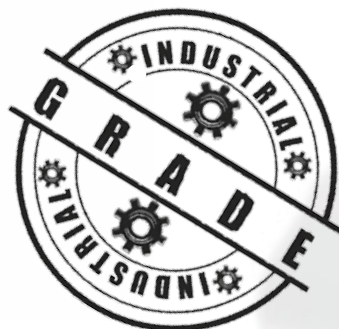

The picture is only for informative purpose.
See the table on page 89 for the complete list of the available optionals.



BR EVO

50 - 90 - 170 - 260



**Battioni®
Pagani**

Setting the pace since 1953

BR-EVO – The evolution

The BR-EVO series of positive displacement rotary lobes pumps is the evolution of the BR pump. Utilized for liquids and muds handling, the BR-EVO requires absence of abrasives and solid bodies less than 30mm wide.

The BR-EVO gearbox is a separate part from the pumping group. This prevents the gearbox to be damaged in case of a break of the mechanical seals.

The BR-EVO features a trilobal lobes design and cooled WIDIA mechanical seals.

The BR-EVO has been specifically designed for in field easy maintenance: rubber lobes, mechanical seals and wear-resistant plates can be replaced without having to remove the pump from the truck system and without having to open the pipes.



VERSIONS

CCW as standard CW as standard



Version P

BR EVO 50

Smooth Cylindrical shaft, Ø 28, lenght: 60 mm

Parallel key UNI 6604

BR EVO 90-170-260

Smooth Cylindrical shaft, Ø 38, lenght: 80 mm

Parallel key UNI 6604

CCW as standard CW as standard

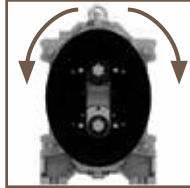

Version D

Splined shaft

1"3/8 - Z6 ISO 500

CCW as standard CW as standard

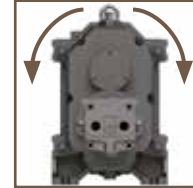

Version H

BR EVO 50: 99.8 cc/rev - Pmax 175 bar -

In G 1/2" - Out G 1/2"

BR EVO 90-170: 201.4 cc/rev - Pmax 175 bar -

In G 3/4" - Out G 3/4"

BR EVO 260: 326.3 cc/rev - Pmax 175 bar -

In G 3/4" - Out G 3/4"

TECHNICAL DATA

	Geometrical capacity			Max rpm			Max Pressure Abs Bar (PSI)			Power Required at Max Pressure kW (hp)			Weight kg		
	m³/h	l/min	cfm	P	D	H	P	D	H	P	D	H	P	D	H
BR EVO - 50	38	633	22	600	600	600	10 (145)	10 (145)	10 (145)	11 (14,7)	11 (14,7)	11 (14,7)	80	82	96
BR EVO - 90	94	1567	55	600	600	600	8 (116)	8 (116)	8 (116)	19 (25,4)	19 (25,4)	19 (25,4)	150	152	176
BR EVO - 170	166	2767	98	600	600	600	8 (116)	8 (116)	8 (116)	29 (38,9)	29 (38,9)	29 (38,9)	165	167	191
BR EVO - 260	283	4718	166	600	600	600	6 (86)	6 (86)	6 (86)	44 (59,0)	44 (59,0)	44 (59,0)	214	216	240

OPTIONALS



SBR Rubber Lobes



FKM Rubber Lobes



EPDM Rubber Lobes



Round Suction Hose Connectors Kit

Code 4440001201
BR EVO 90
Code 4440001202
BR EVO 170
Code 4440001203
BR EVO 260



Square Suction Hose Connectors Kit

Code 4011501034
BR EVO 90
Code 4011501035
BR EVO 170



Overpressure Valve 2" - 2" 1/2

Code 5100200033
BR EVO 50 - 90 - 170
Code 5100200034
BR EVO 260



Elbows Kit

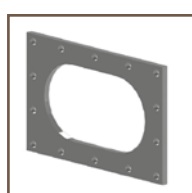

Coupling Flange BR EVO 90
Code 4440001200



Customized Painting



FLOW-PRESSURE CHARTS

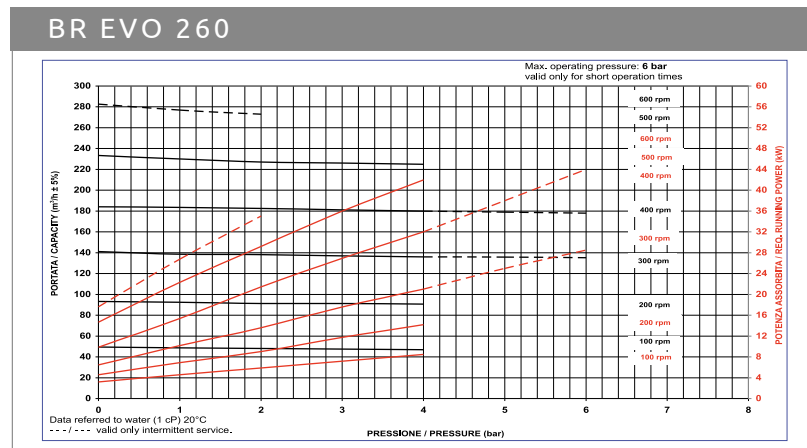
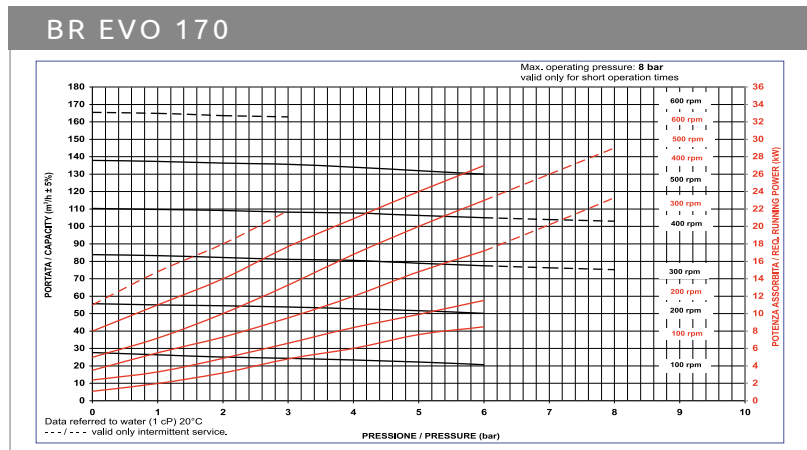
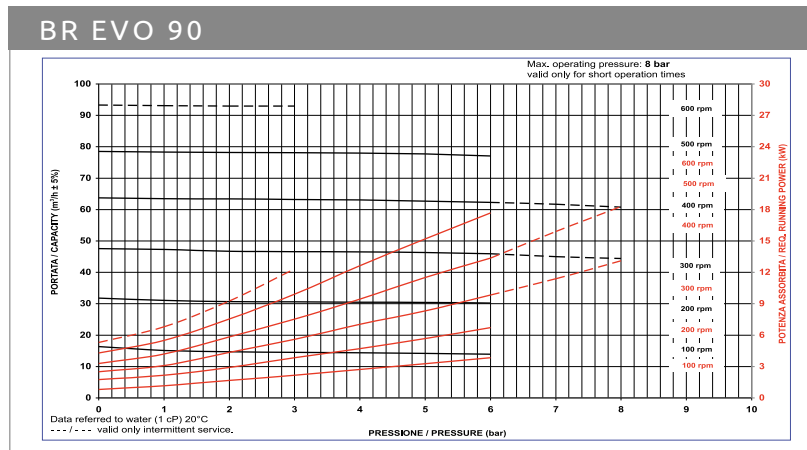
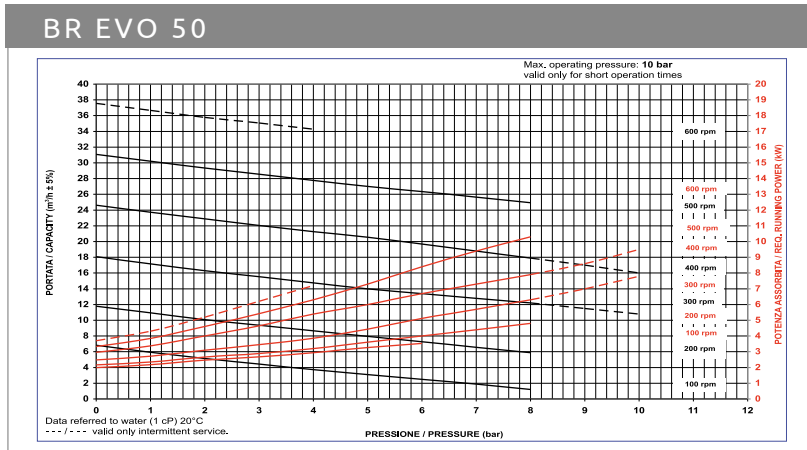

Self Priming Rotary Lobe
Liquid Transfer Pumps



Battioni®
Pagani

Setting the pace since 1953



Battioni Pagani Pompe S.p.A.

Via Enzo Ferrari, 2
43058 Sorbolo (PR) - Italy

Ph. +39 0521 663203

Fax +39 0521 663206



www.bapag.it
info@bapag.it

